







LEGEND

-  WETLANDS
-  WOODS
-  LAWN AREA
-  AGGREGATE TRAIL
-  BITUMINOUS TRAIL
-  HANDICAP PARKING
-  NATIVE MEADOW GRASSES

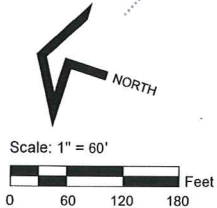
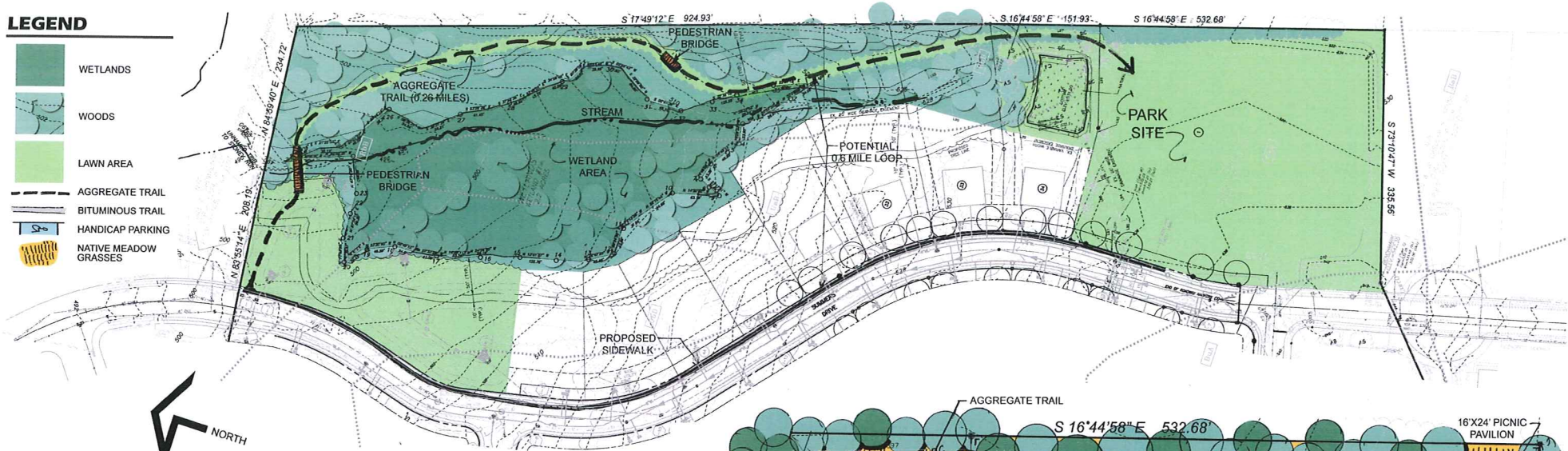

Stoney Pointe Park

Pre-Final Master Plan

East Cocalico Township, Lancaster County, Pennsylvania
March 2011

Site Data:
Park Site Coverage = 3.30 Acres
Master Plan Study Area = 9.90 Acres

Site Soils:
L1B- UNGERS LOAM 3.8% SLOPES
L1D- UNGERS EXTREMELY STONEY LOAM 8-25% SLOPES
B1+- BLUES SILT LOAM 0.3% SLOPES
R1B- READINGTON EXTREMELY STONEY SILT LOAM 3.8% SLOPES

PREPARED BY:

BECKER
ENGINEERING
110 MILLERSVILLE ROAD
LANCASTER, PA 17303
717-393-8111 / 717-393-8112
WWW.BECKEREING.COM

ysm
Landscape Architects
10 Sun Nookway Street
York, Pennsylvania 17402
(717) 830-0999 phone
(717) 830-0769 fax
www.ysm.com

